

PUBLIC MEETING
February 19, 2009

Erie Waterfront Master Plan

**Erie Western-Pennsylvania
Port Authority**

Erie, Pennsylvania



DOMOKUR | ARCHITECTS

domokur



AGENDA

- Master Plan Process
- Historic Changes to the Bayfront
- Existing Land Conditions
- Existing Land Use Analysis
- Proposed Land Use
- Master Plan
- Master Plan Recommendations
- Question / Comments
- Review Master Plan in Lobby

MASTER PLAN PLANNING PROCESS AND GOAL

GOAL

Create a **clear vision** for development on the Erie Waterfront over the next 10 years that supports the Erie-Western Pennsylvania Port Authority's Mission: "To promote industrial, commercial, and recreational opportunities for the citizens of Pennsylvania on Presque Isle Bay and adjacent waters."

PROCESS

- Update Survey / Existing Conditions of Erie Bayfront
- Evaluate & Document Projects in Planning Stages
- Analyze Existing Conditions and Land Uses on Bayfront
- Develop Conceptual Ideas for Future Land Use
- Interview Key Persons Throughout Process/Study Committee Reviews
- Present Ideas to the Community for Additional Input
- Develop Preliminary and Final Master Plan Draft
- **Present Final Draft Plan to Community**
- Summarize Master Plan - Executive Report with Cost Opinions & Phasing

CHANGES TO THE BAYFRONT



**LAWRENCE PIER
&
NIAGARA PIER**



CHANGES TO THE BAYFRONT



**SASSAFRAS PIER
&
CANAL BASIN**



EXISTING CONDITIONS



EXISTING LAND USE & CIRCULATION ANALYSIS

OPPORTUNITIES

- Abundant Public Waterfront Access
- Generous amount of Public Spaces
- Well-designed Trails
- Industrial / Working Port in Remote Location w/ Space for Expansion
- Variety of Public and Private Boat Launch Locations



EXISTING LAND USE & CIRCULATION ANALYSIS

CONSTRAINTS

- Disconnected Spaces
- Underutilized Areas
- Limited East-West Connections on Bayfront
- Lack of Connections from Bayfront to Downtown and Neighborhoods
- Bayfront Parkway lacks 'Parkway' Feel
- Minimal Housing / Commercial / Retail Options

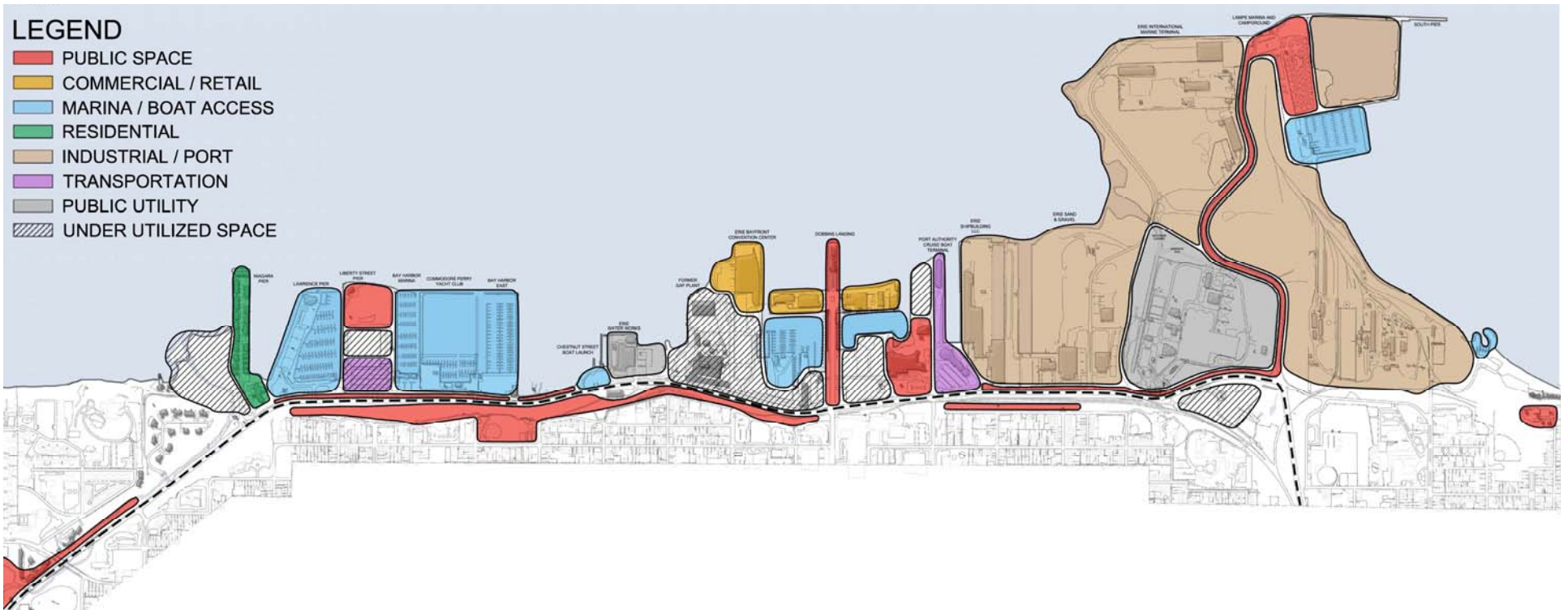

PROPOSED LAND USE & CIRCULATION SOLUTIONS

- Increase and Enhance Public Spaces
- Develop Contiguous Public Space Connections
- Expand Industrial/Working Port Facilities as Opportunities Arise
- Maintain Marina Facilities along the Bayfront
- Create Mixed-use Development Areas including a Distinctive Central Bayfront District
- Connect the Bayfront to Downtown Erie and Nearby Neighborhoods
- Establish a True Parkway along the Bayfront



PROPOSED LAND USE & CIRCULATION SOLUTIONS

CENTRAL BAYFRONT DISTRICT

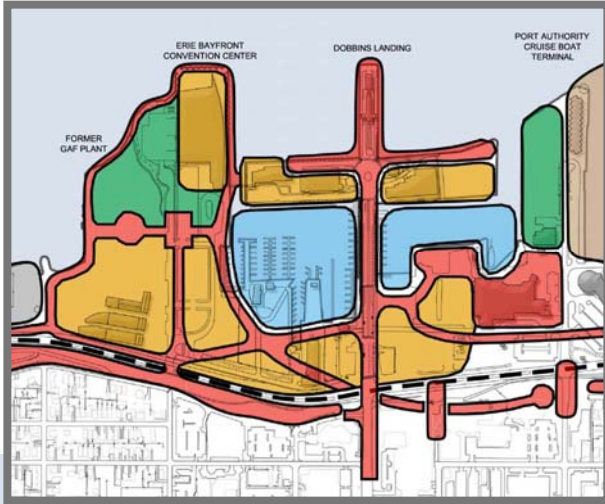

LEGEND

- PUBLIC SPACE
- COMMERCIAL / RETAIL
- MARINA / BOAT ACCESS
- RESIDENTIAL
- MIXED USE DEVELOPMENT
- PUBLIC UTILITY
- INDUSTRIAL / PORT

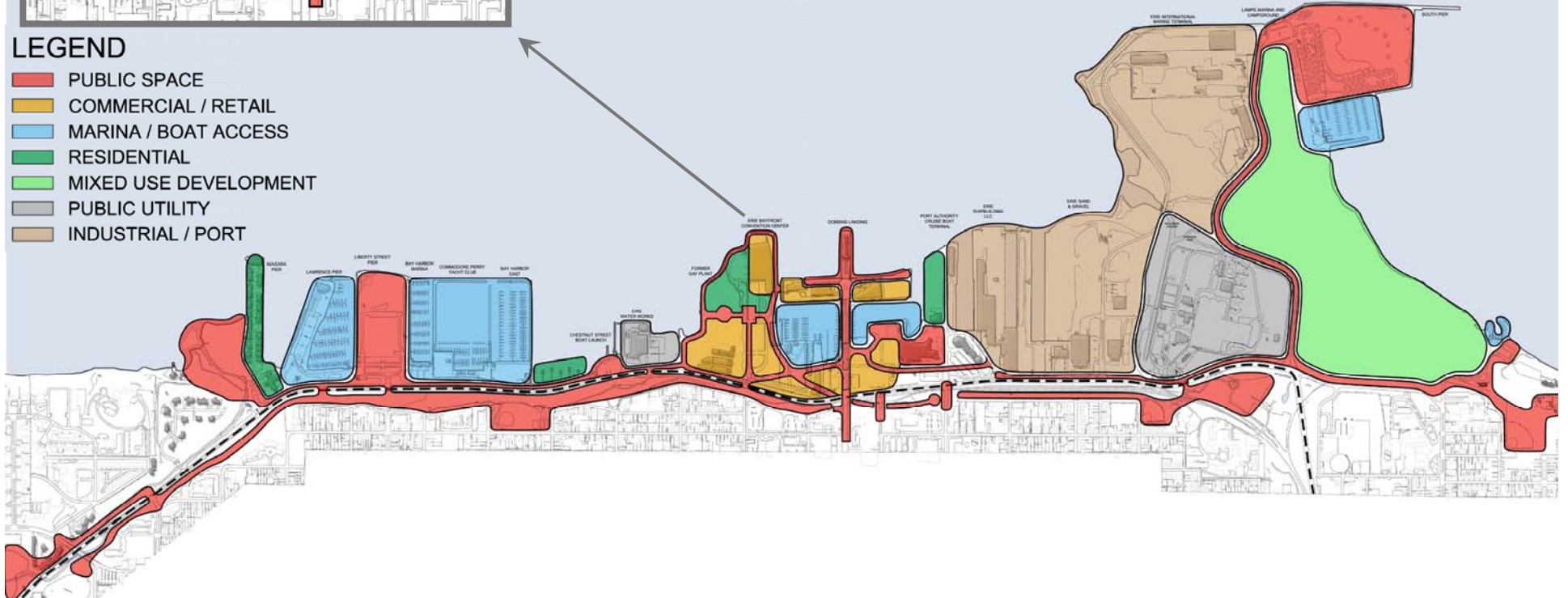

MASTER PLAN

- Public Access
- **Recreational Spaces**
- Social Spaces
- Local Character
- Economic Development
- **Historical and Cultural Resources**
- Environmental Sustainability
- Accessibility

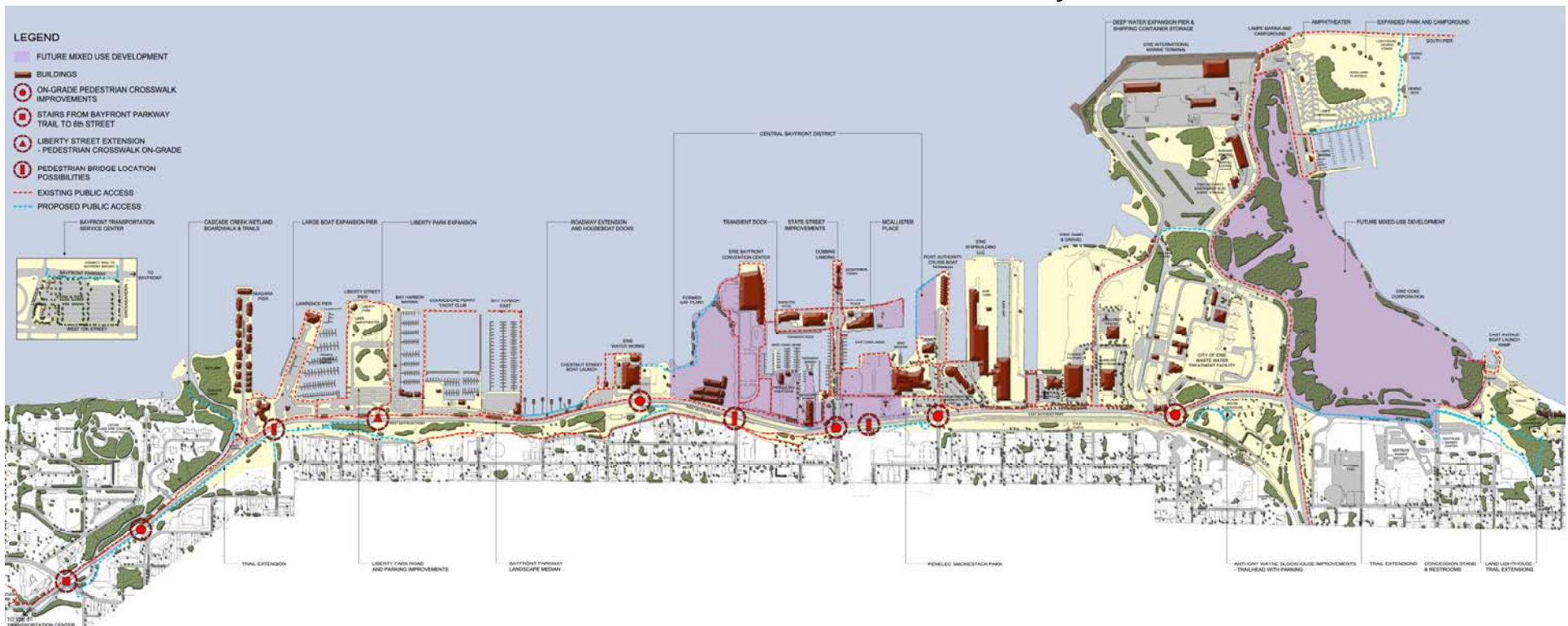

CIRCULATION & LANDUSE

PEDESTRIAN CIRCULATION

PEDESTRIAN CROSSWALKS & BRIDGES



Recommendations

PEDESTRIAN BRIDGES

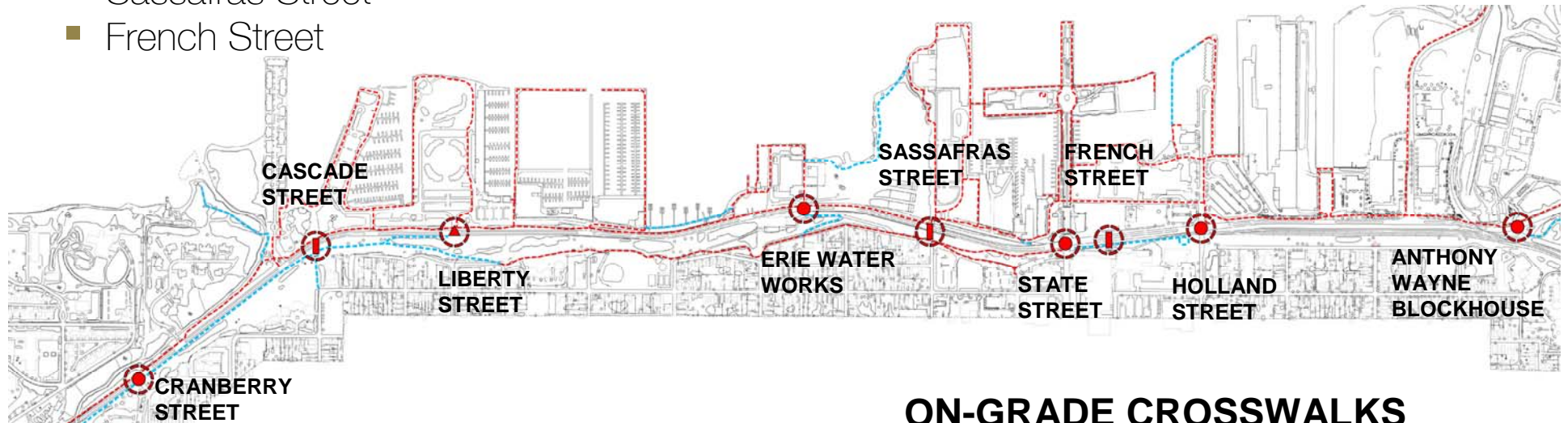
- Cascade Street
- Sassafras Street
- French Street



LEGEND

-  ON-GRADE PEDESTRIAN CROSSWALK IMPROVEMENTS
-  STAIRS FROM BAYFRONT PARKWAY TRAIL TO 6th STREET
-  LIBERTY STREET EXTENSION - PEDESTRIAN CROSSWALK ON-GRADE
-  PEDESTRIAN BRIDGE LOCATION POSSIBILITIES

ON-GRADE CROSSWALKS

- Cranberry Street
- Liberty Street
- Erie Water Works
- State Street
- Holland Street
- AW Blockhouse

PEDESTRIAN CIRCULATION

PEDESTRIAN CROSSWALKS

- Immediate Solutions Due to Costs
- Traffic Lights or Flashing Crossing Lights
- Pedestrian Crossing Signage
- Pavement Texture and Color
- Raised Crosswalks
- Pedestrian Amenities -Trash Containers-Benches-Landscaping
- Widened Pedestrian Landings at Crosswalks
- Sidewalks and Trails Extended to Crosswalks



PEDESTRIAN CIRCULATION

PEDESTRIAN CROSSWALKS

- Immediate Solutions Due to Costs
- Traffic Lights or Flashing Crossing Lights
- Pedestrian Crossing Signage
- Pavement Texture and Color
- Raised Crosswalks
- Pedestrian Amenities -Trash Containers-Benches-Landscaping
- Widened Pedestrian Landings at Crosswalks
- Sidewalks and Trails Extended to Crosswalks



IN-PAVEMENT LIGHTS
– PEDESTRIAN ACTIVATED



PAVEMENT COLORS / PATTERNS



OVER-HEAD SIGNS / LIGHTS

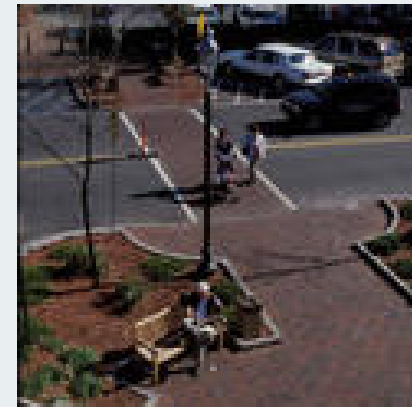

WIDENED XWALK LANDING/FURNISHINGS

PEDESTRIAN CIRCULATION

PEDESTRIAN CROSSWALKS

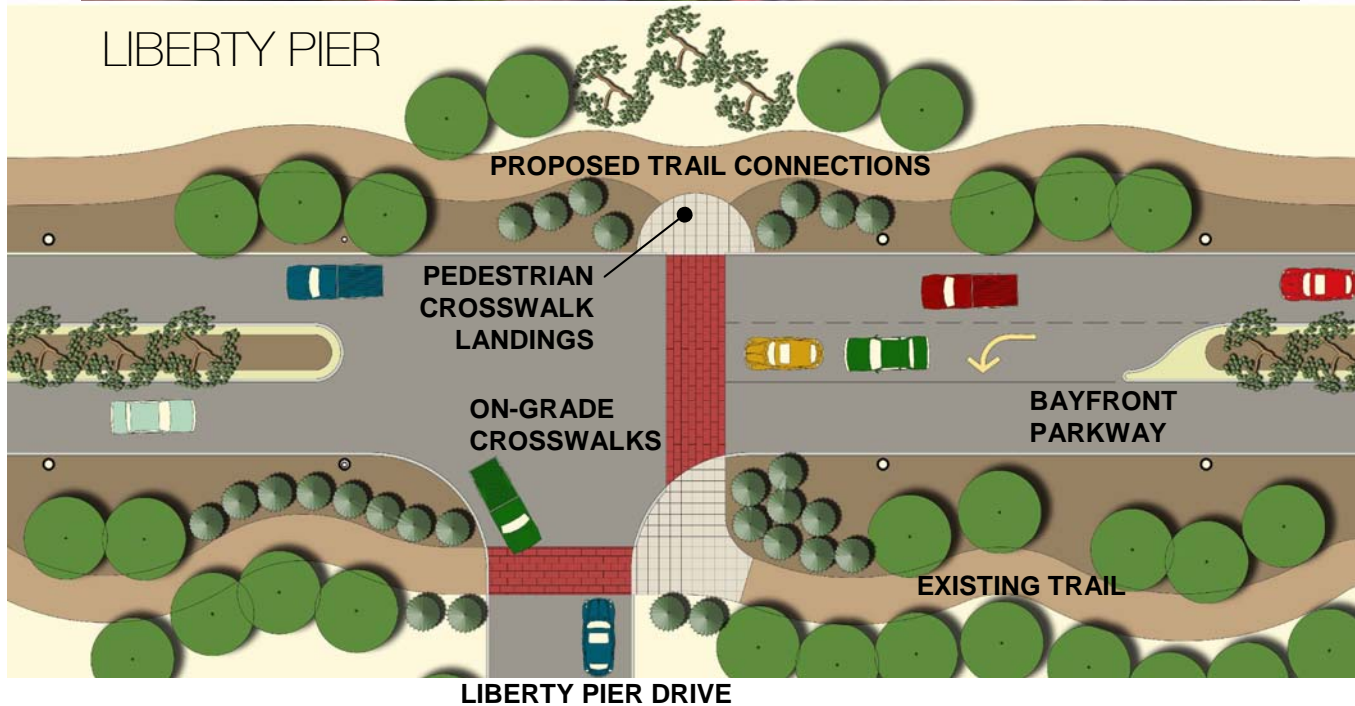

PEDESTRIAN CIRCULATION

PEDESTRIAN CROSSWALKS

Crosswalk with Pedestrian Island



Cranberry Street at Bayfront
Parkway



PEDESTRIAN ISLAND

PEDESTRIAN CIRCULATION

PEDESTRIAN CROSSWALKS

- Develop as Major Pedestrian Connection to Bayfront
- Expanded Pedestrian Landings at Corner
- Decorative Pavement Improvements in Intersection
- Decorative Lighting
- Pedestrian Scale & Amenities
- Landscape Plantings

State Street at Bayfront
Parkway



domokir

PEDESTRIAN CIRCULATION

PEDESTRIAN BRIDGES

- More Direct and Safer Connections Across Parkway
- Opportunity to Negotiate Elevation of Bluff and Bayfront
- Avoid Blocking Views of Bayfront
- Designs should be Complimentary to Bayfront Character
- All must be Accessible



UNDERSTATED



ICONIC STATEMENT

PEDESTRIAN CIRCULATION TRAIL AND SIDEWALK CONNECTIONS

- Connect Downtown, Neighborhoods, and Bayfront
- Connect Existing Trail Systems
- Connect Trails and Sidewalks to Proposed Crosswalks
- Connect Trails to Attractions & Public Spaces along Bayfront

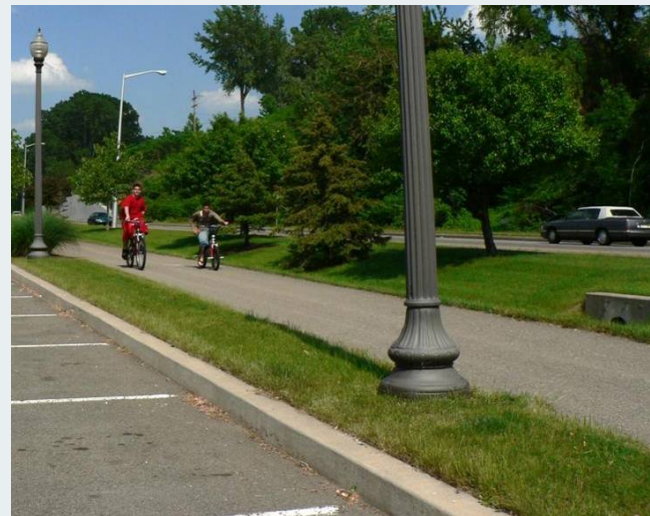

PEDESTRIAN CIRCULATION TRAIL AND SIDEWALK CONNECTION Recommendations

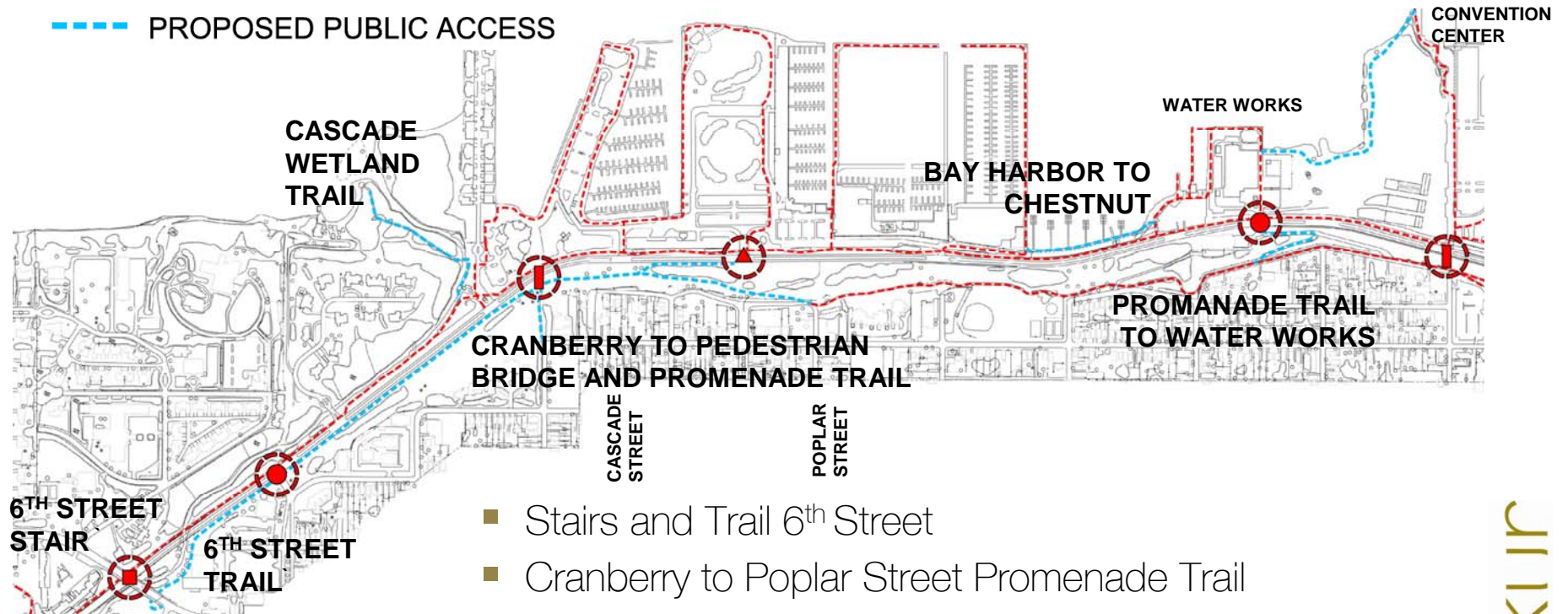

- Stairs and Trail 6th Street
- Cranberry to Poplar Street Promenade Trail
- Connection to Cascade Bridge-Liberty Crosswalk
- Pedestrian Bridge to Promenade Trail
- Cascade Creek Wetlands Trail
- Promenade Trail to Water Works
- Bay Harbor Area to Chestnut Street Boat Launch
- Water Works to Convention Center

PEDESTRIAN CIRCULATION TRAIL AND SIDEWALK CONNECTION Recommendations

- Bayfront Trail to Holland Street via RR Underpass
- Trailhead & Access to Anthony Wayne Blockhouse
- Water Edge Trail & Overlooks at Lampe Marina
- Bayfront Trail Extension to Land Lighthouse
- Ore Dock Road to Port Access Road

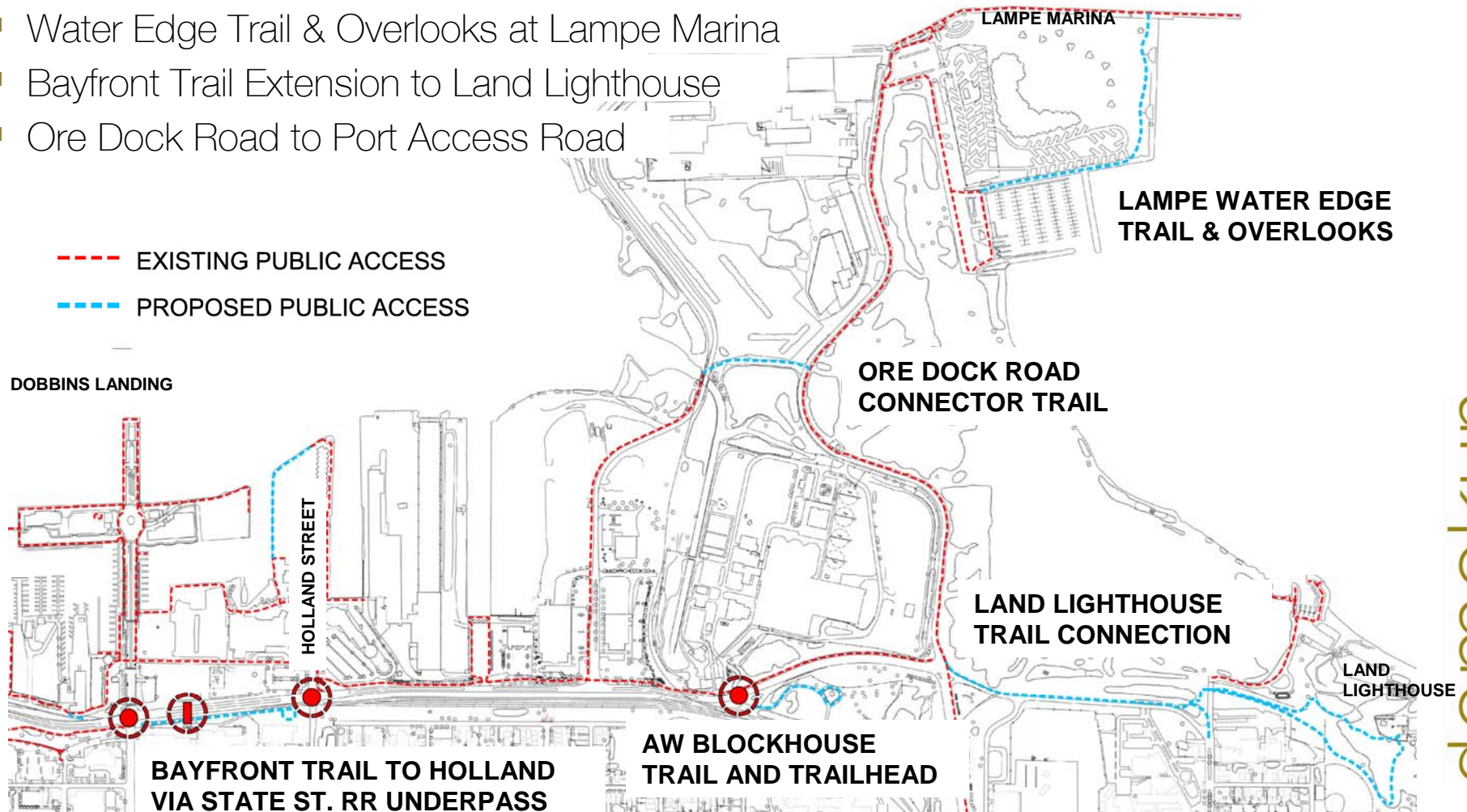

VEHICULAR CIRCULATION ROADWAY ENHANCEMENT, PARKING & TRANSPORTATION Recommendations

- Bayfront Parkway Enhancements
- State Street Enhancements
- Bayfront Roadway & Trail Extension near Chestnut St. Boat Launch
- Liberty Street Extension to Parkway Study
- Implement Intermodal Transportation Concepts
- Expanded Use of Parking Garages on Bayfront

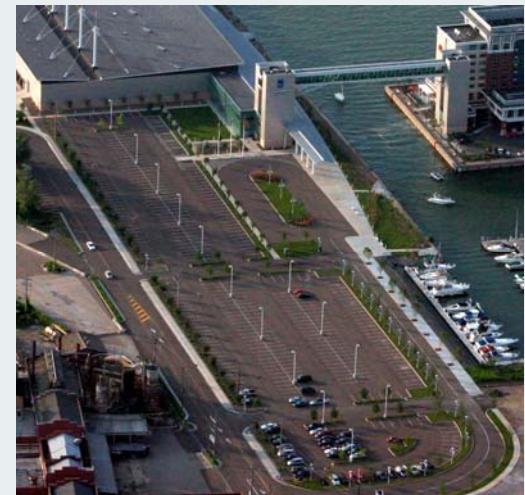

VEHICULAR CIRCULATION

BAYFRONT PARKWAY ENHANCEMENTS

SOFTEN WALLS



Landscape Median on Bayfront Parkway

- Traffic Calming
- Visual Enhancement
- Function more as a Parkway
- 6th Street to Port Access Road

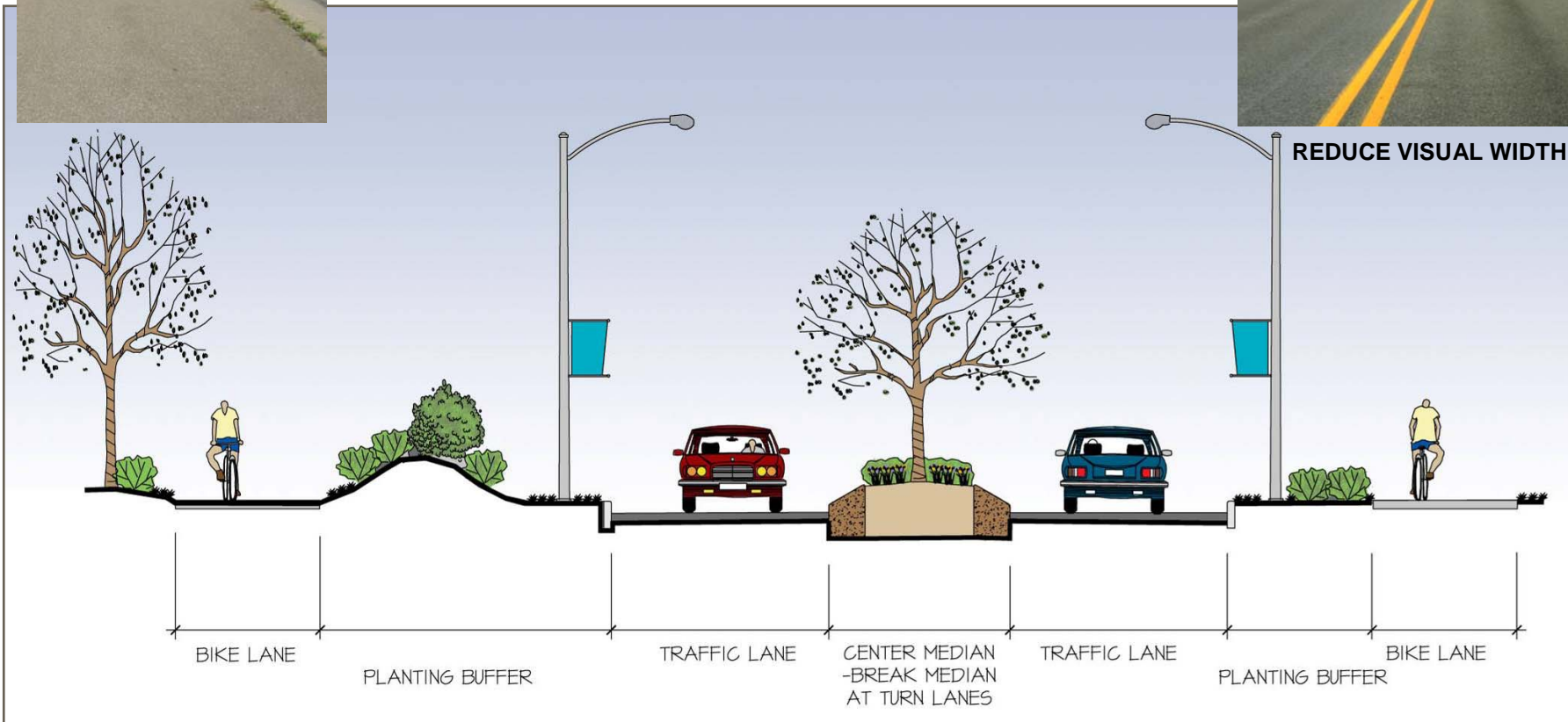
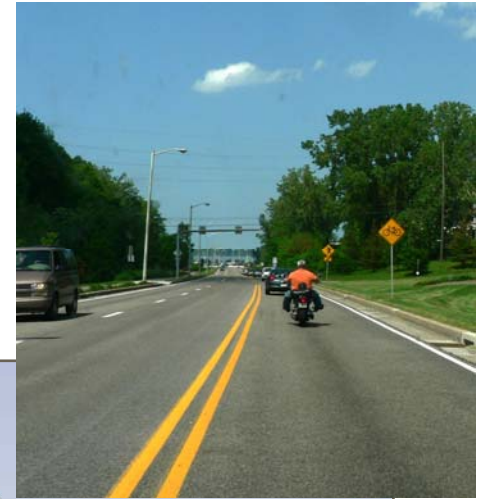

VEHICULAR CIRCULATION

BAYFRONT PARKWAY ENHANCEMENTS

Landscape Median on Bayfront Parkway

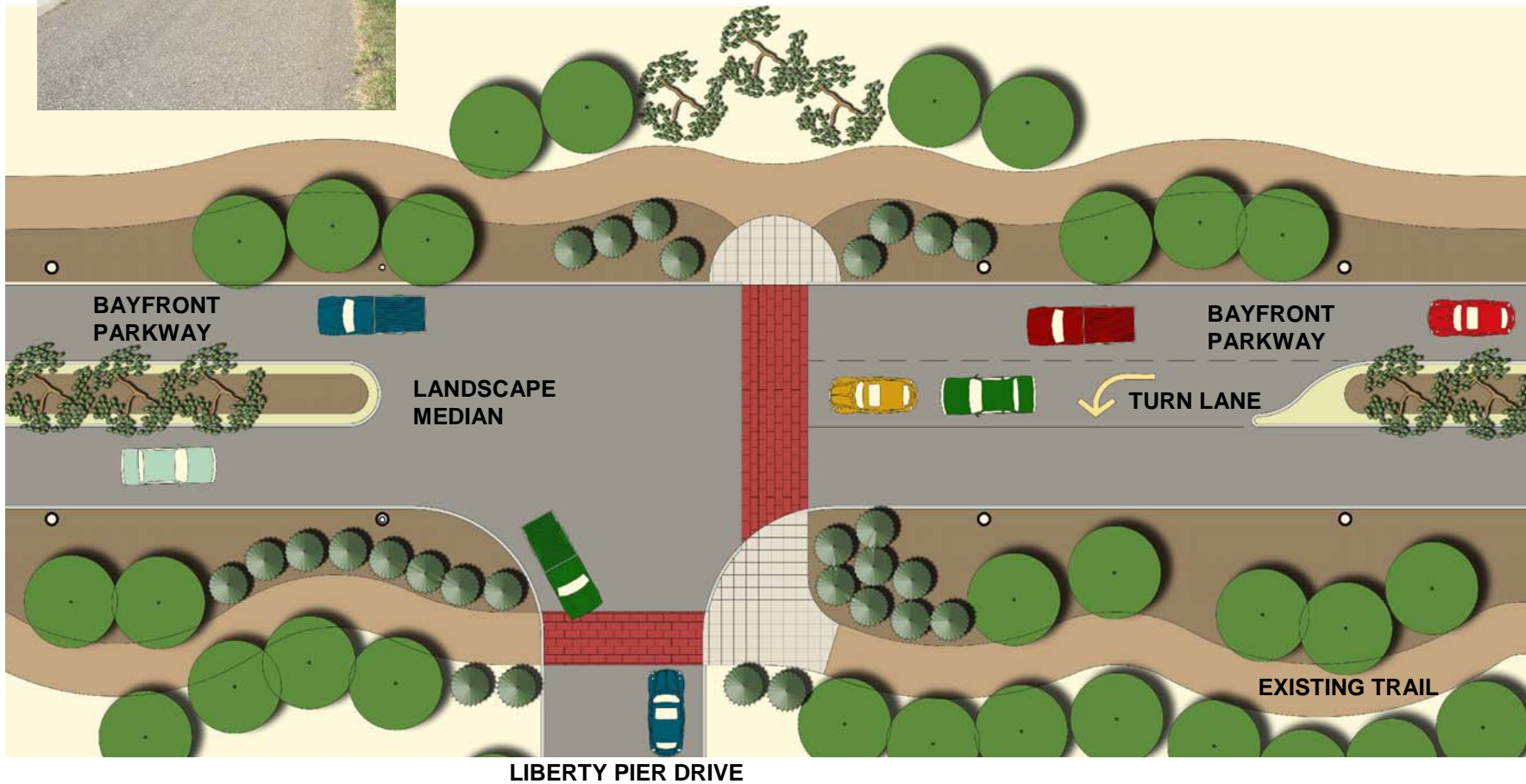

VEHICULAR CIRCULATION STATE STREET ENHANCEMENTS

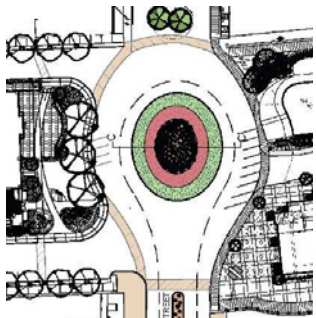

ENHANCE
DRIVE
LOOP

LANDSCAPE
BOULEVARD
DEVELOPMENT

ANGLED &
INCREASED
PARKING

ENHANCED
PEDESTRIAN
BOARDWALKS

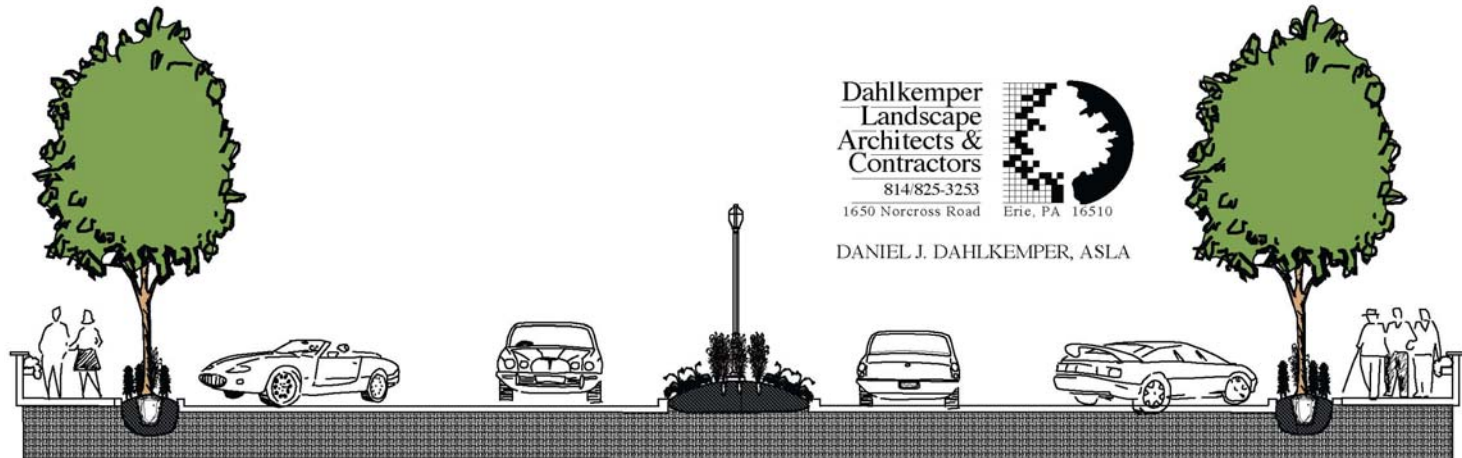
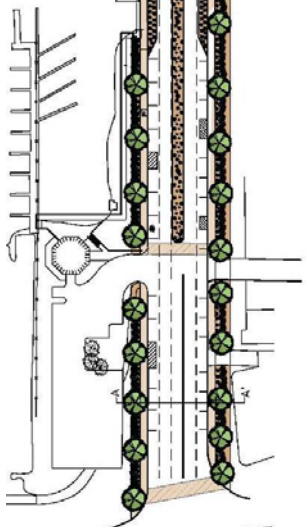

Boardwalk

Landscaping Strip

Angled Parking

Driving Lane

Landscaping Median

Driving Lane

Angled Parking

Landscaping Strip

Boardwalk

Dahlkemper
Landscape
Architects &
Contractors
814/825-3253
1650 Norcross Road

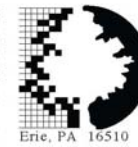

Erie, PA 16510

DANIEL J. DAHLKEMPER, ASLA

dahlkemper

VEHICULAR CIRCULATION BAYFRONT ROADWAY & TRAIL EXTENSION

- Extends East-West Roadway Connection
- Expands Public Access along Water Edge
 - Pedestrian-Scale Lighting
 - Pedestrian Amenities - Trash Receptacles, Benches
 - Landscape Plantings
- Added Bayfront Housing Option with Houseboat Docks

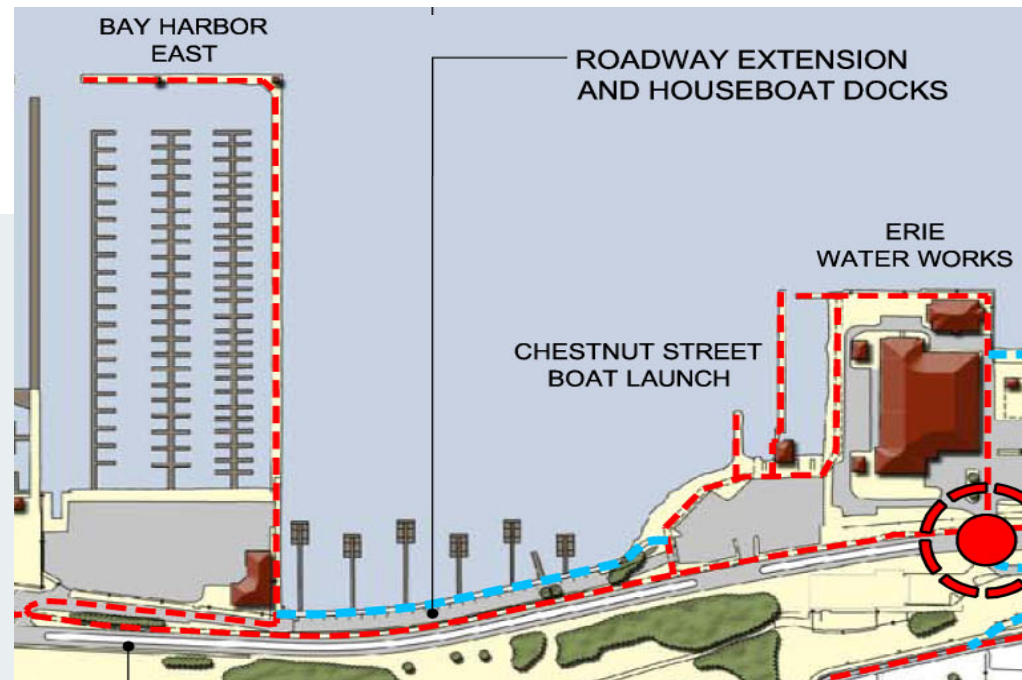

VEHICULAR CIRCULATION BAYFRONT ROADWAY EXTENSION

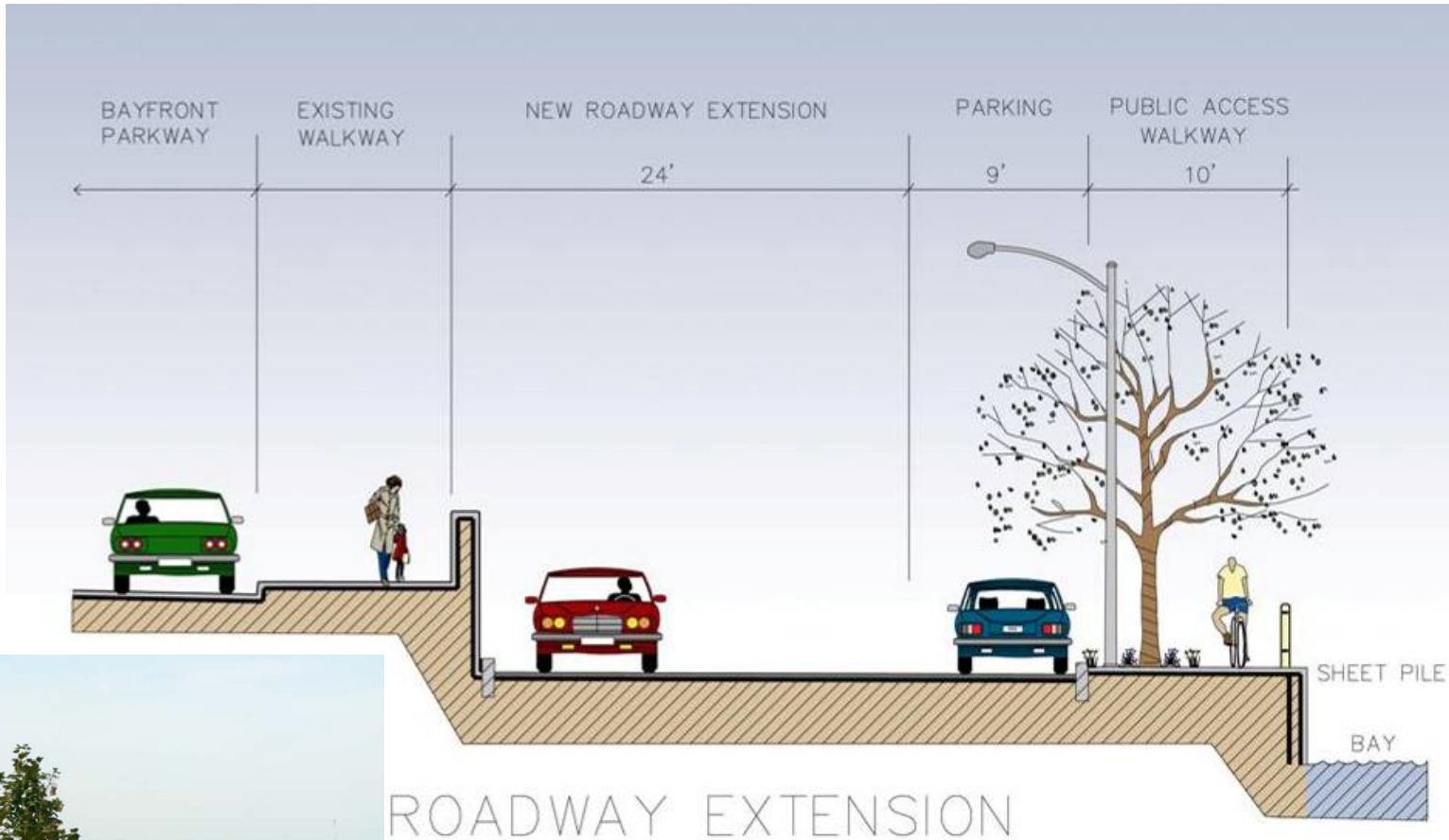

VEHICULAR CIRCULATION

BAYFRONT PARKING & INTERMODAL TRANSPORTATION

Reduce Traffic on Bayfront Parkway

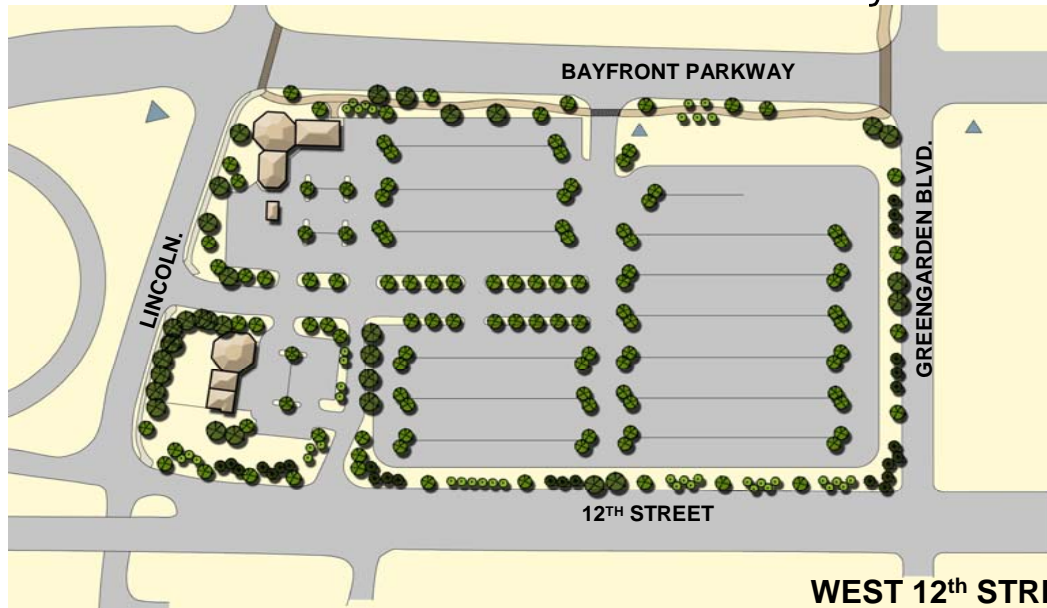

WEST 12th STREET PARK 'N' RIDE

- Real-time Messaging Information Kiosks
- Bayfront Mobility Initiative
 - Develop Transit Parking Anchors
 - W. 12th Street Park n Ride
 - Graduated Parking Fees
- Maintain & Expand Free Trolley Service
- Reduce Traffic on Bayfront Parkway



VEHICULAR CIRCULATION BAYFRONT PARKING GARAGES

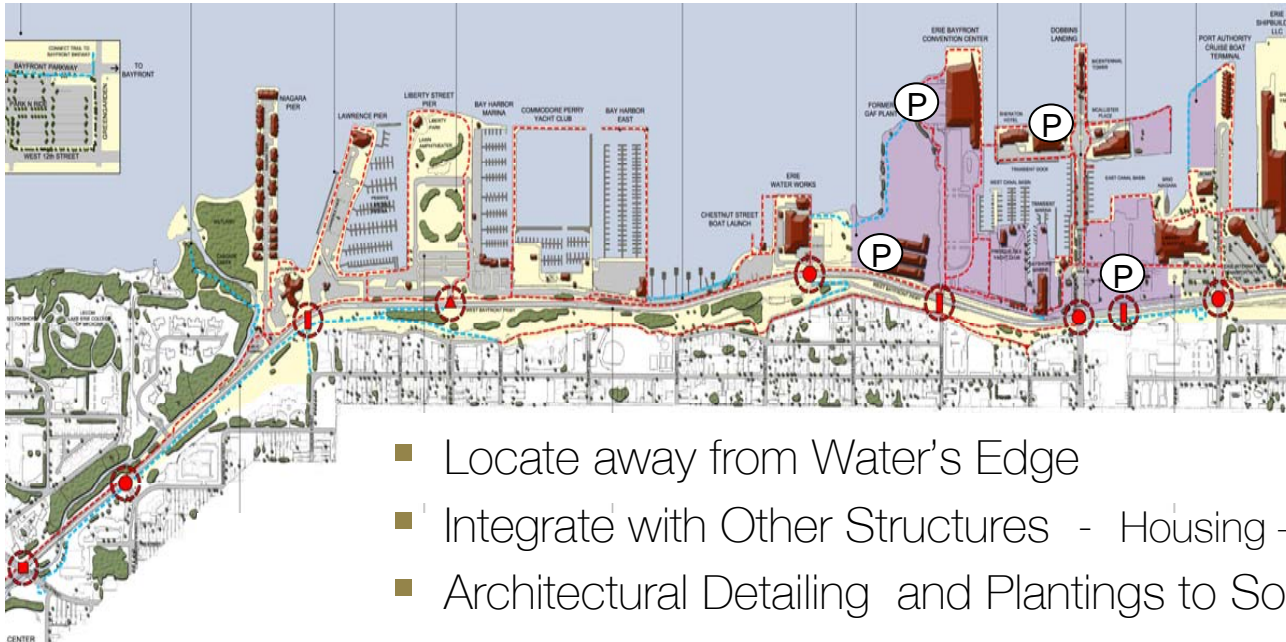

- Potential Locations
 - Former GAF Site
 - Convention Center
 - East of State Street

- Locate away from Water's Edge
- Integrate with Other Structures - Housing – Retail – Commercial
- Architectural Detailing and Plantings to Soften



LAND USE IMPROVEMENT Recommendations

- Central Bayfront District Improvements
- Large Boat Pier Development
- Liberty Park Expansion
- Working Port Expansion
- Lampe Marina Expansion
- East Avenue Boat Launch Improvements
- Land Lighthouse Connection
- Environmental Sustainability
- Historical/Cultural Resource Enhancement

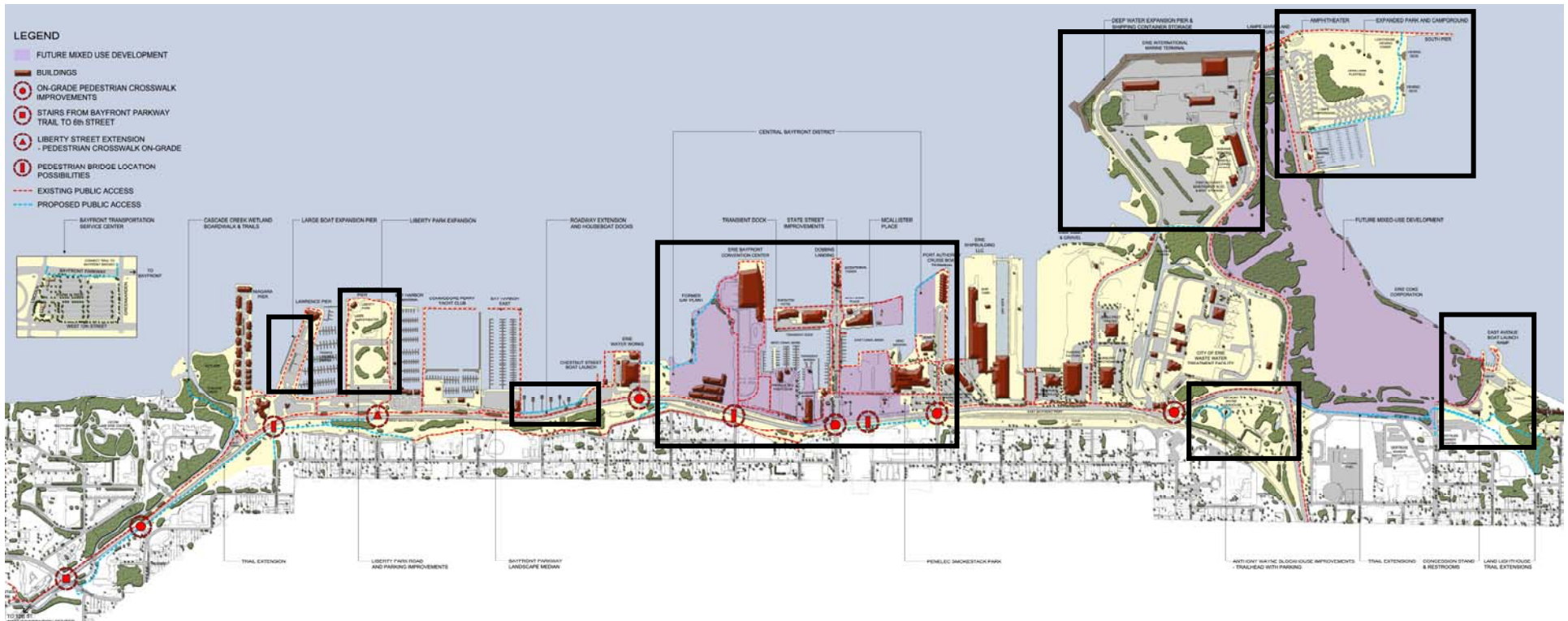

LAND USE IMPROVEMENTS

CENTRAL BAYFRONT DISTRICT

- Integrated Mixed-use Development
 - Residential
 - Retail - Commercial
 - Entertainment and Civic Venues
 - Social Spaces / Pedestrian Connections / Access
- Continuous Public Waterfront Access
- **State Street as a Central Spine**
- **Strong Connections to Downtown**
- **Plan District as a Unified Whole**
- Maritime Character
 - Spaces, Structures, Site Furnishing
- Adaptive Reuse of Older Structures
- Collaborative Planning & Partnerships
 - City & County Government
 - Port Authority
 - Community
 - Local Business Community
 - Developers
 - Bayfront Property Owners

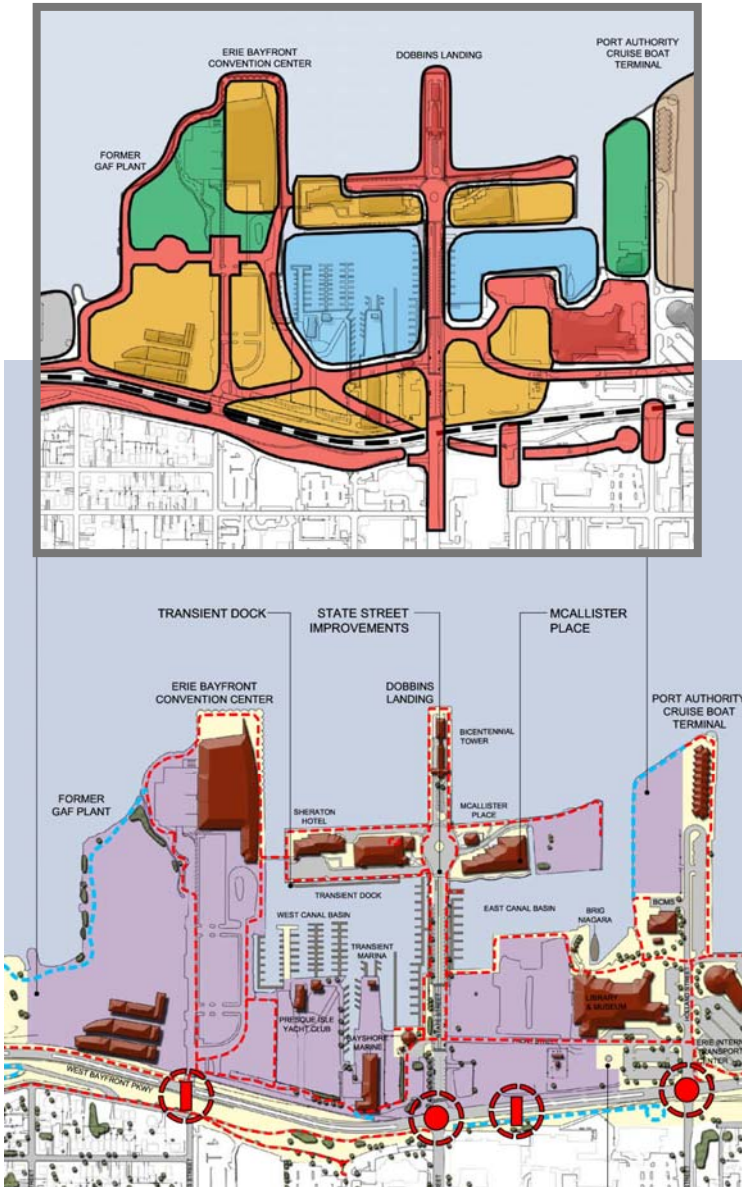

LAND USE IMPROVEMENTS CENTRAL BAYFRONT DISTRICT

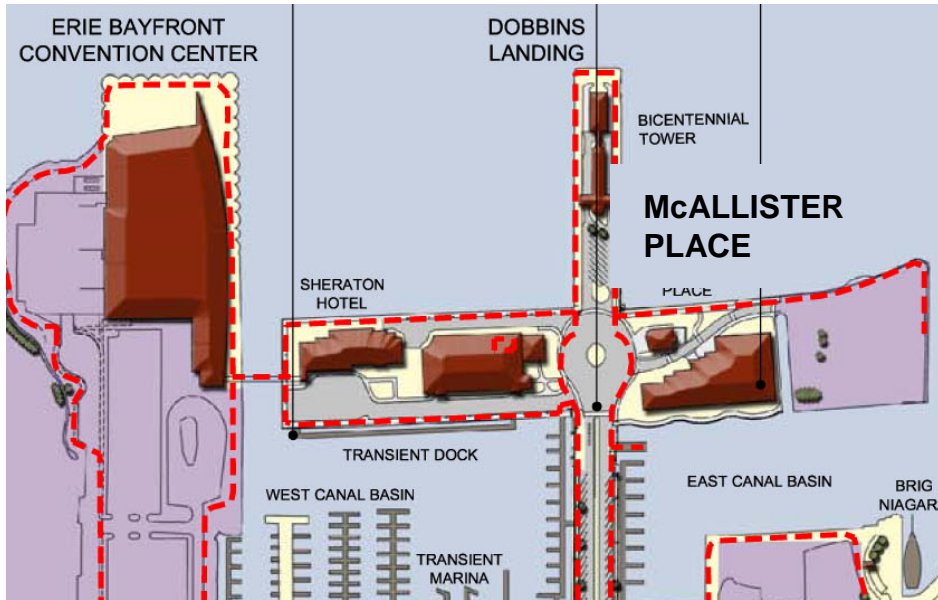

McAllister Place Development

- Mixed Uses
 - Residential
 - Commercial
 - Retail
 - Parking
- Retail Stores
 - Exterior & Interior Storefront Access
- Generous Public Space & Pedestrian Waterfront Access

Plans by RB Architects w/
Dalhkeper Landscape Architects



RBArchitects
ARCHITECT • PLANNER • INTERIOR



RBArchitects
ARCHITECT • PLANNER • INTERIOR

domokir

LAND USE IMPROVEMENTS

CENTRAL BAYFRONT DISTRICT



BALTIMORE HARBOR RE-USE

Transient Dock Expansion

- Near Hotel and Convention Center
- Public Day Use

Adaptive Re-Use Opportunities

- Former GAF Plant Buildings/Structures
- Opportunity for Building Reuse
- Historic Preservation Opportunities



LAND USE IMPROVEMENTS

CENTRAL BAYFRONT DISTRICT

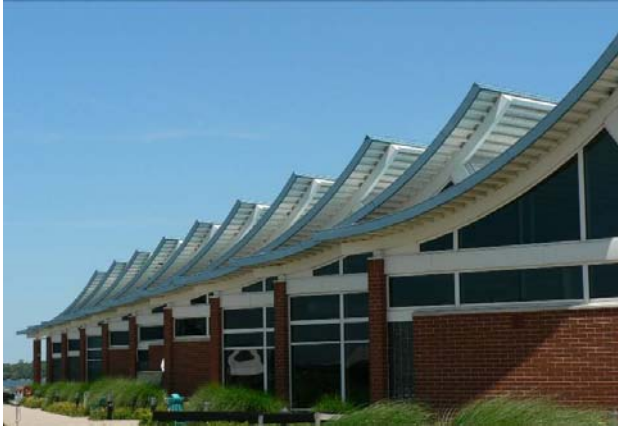

Character of the Central Bayfront District

- Good Start
- Coordinate Development



domokir

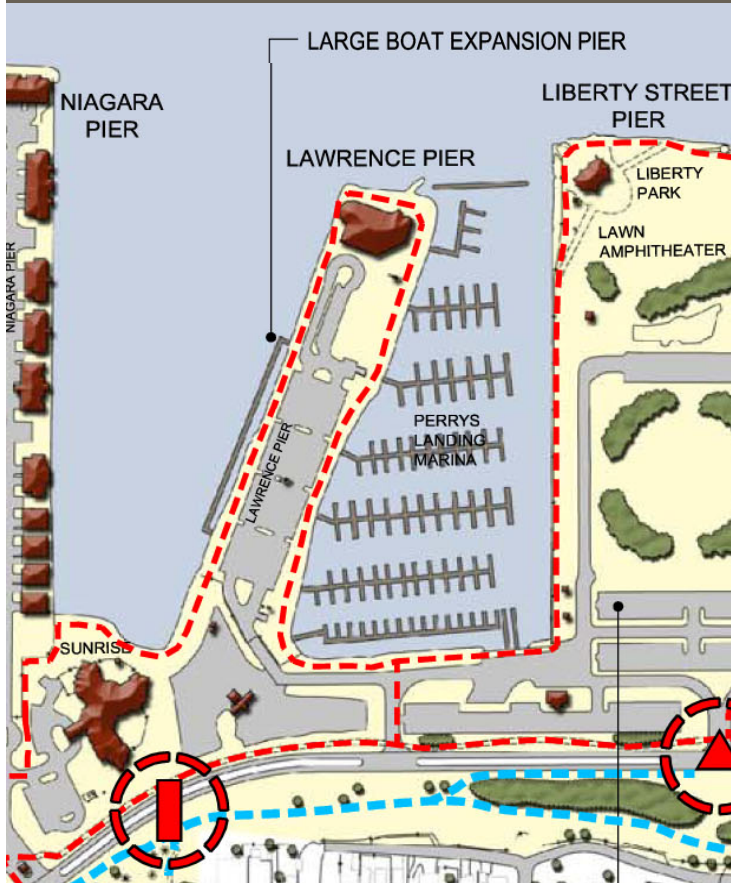

LAND USE IMPROVEMENTS

LARGE BOAT EXPANSION PIER

- Deep Water Area
- Provide Docks for Large Pleasure Boats
- Facility that is Lacking on the Bayfront





LAND USE IMPROVEMENTS

LIBERTY PARK EXPANSION

- Expand Park Area
- Resolve Ownership Issues
- Expand Trails in Park
- Proposed Concession Stand
- Winter Boat Storage in Parking Areas
- Environmentally Sensitive Lighting
 - Replace or Modify existing
 - Separate into Lighting Zones
 - Provide Light Cut-offs
- Decrease Impervious Pavement
- Integrate Bio-Retention Paved Areas



LAND USE IMPROVEMENTS WORKING PORT EXPANSION

- Expand Deepwater Shipping Pier
- Develop Container Storage Area
- Additional Room for Expansion



LAND USE IMPROVEMENTS

LAMPE MARINA EXPANSION



LAMPE MARINA EXPANSION

- Expand Park and Campgrounds
- Fill CDF for Additional Land
- Develop Amphitheater
- Expand Public Waterfront Access
- New Viewing Tower and Decks

EAST AVENUE BOAT LAUNCH

- New Concession / Restroom Facility



LAND USE IMPROVEMENTS

LAND LIGHTHOUSE

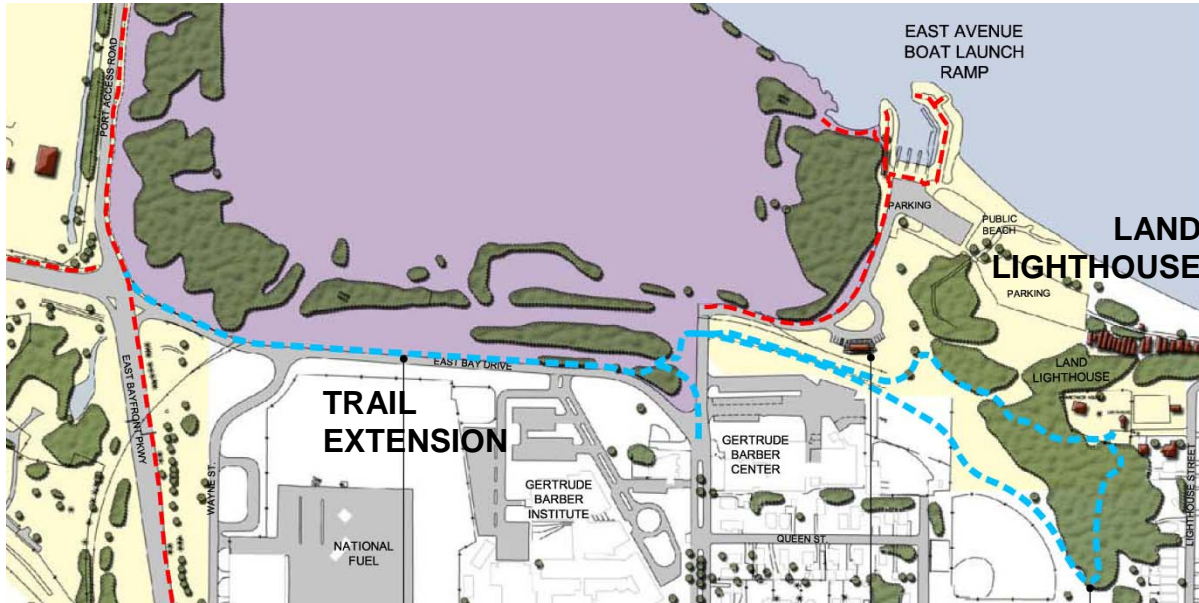

- Extend Bayfront Trail to Land Lighthouse
- Land Lighthouse becomes Bayfront Terminus
- Port Authority attain Ownership & Responsible for Maintenance
- Implement Land Lighthouse Master Plan



LAND USE IMPROVEMENTS

ENVIRONMENTAL SUSTAINABILITY

Implement Sustainable Practices in all New Development

- Bio-swales in Pavement Areas
- Permeable Pavement Materials
- Sun Shading on Buildings
- Green Roofs on Buildings
- Adaptive Re-Use of Existing Structures
- Material Re-Use

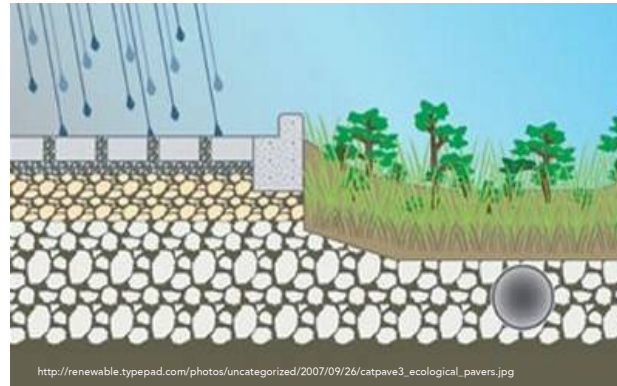

LAND USE IMPROVEMENTS

HISTORICAL & CULTURAL RESOURCES



- Preserve
- Connect
- Interpret
- Celebrate



domokir

LAND USE IMPROVEMENTS HISTORIC & CULTURAL RESOURCES

- Develop Access to Historic & Cultural Sites
- Preserve Visual & Conceptual Connections to Local History and Culture
- **Preserve & Create Social Spaces in Conjunction with Sites for Gathering**
- Interconnect Sites with Wayfinding Techniques – Signage – Markings
- Establish Consistency in all Signage for Recognition
- Install Interpretive Signage & Art to Inform the Public
- **Provide Adequate Maintenance**





Please
Meet in the Lobby for
Questions and Comments

Thank you!



domokur

DOMOKUR | ARCHITECTS